

MAYFAIR AT AVALON

*The Camellia* TWO-STORY RESIDENCE

4 Bedroom – 3 Bath – Loft – 2-Car Garage | 2,849 - 3,063 SQ. FT.

OPTIONS: Powder Bath, Bedroom 5, Master Bath Tub/Spa Shower, Expanded Dining, California Room or Expanded Dining with California Room



*Preliminary*



A

THE SPANISH  
ELEVATION



B

THE EUROPEAN  
COTTAGE ELEVATION

*Shown with Optional  
Stone Accents*



C

THE FRENCH  
COUNTRY ELEVATION

*Shown with Optional  
Stone Accents*



*Elevations depicted in the brochure are an artist rendering and do not necessarily reflect standard elevation features, landscaping, lighting, entry or garage doors. All stonework is an option.*

 Broker #  
01112962

MAYFAIR AT AVALON

*The Camellia* TWO-STORY RESIDENCE

4 Bedroom – 3 Bath – Loft – 2-Car Garage | 2,849 - 3,063 sq. ft.

OPTIONS: Powder Bath, Bedroom 5, Master Bath Tub/Spa Shower, Expanded Dining, California Room or Expanded Dining with California Room



Preliminary

LOWER LEVEL



OPTION: Expanded Dining and California Room (Adds 215 Sq. Ft.)



OPTION: California Room

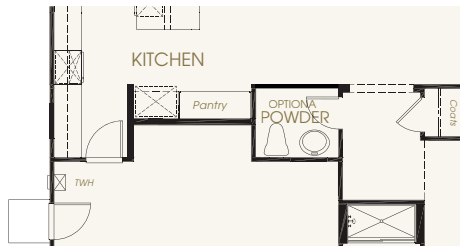

OPTION: Powder Bath in lieu of Launch



FLOOR PLAN | SPANISH ELEVATION



In an effort to continuously improve our product, we reserve the right to change elevations, specifications, materials, and price without prior notice. Variations in the floor plans and elevations may exist and square footages are approximate.

Broker #  
01112962

MAYFAIR AT AVALON

*The Camellia* TWO-STORY RESIDENCE

4 Bedroom – 3 Bath – Loft – 2-Car Garage | 2,849 - 3,063 SQ. FT.

OPTIONS: Powder Bath, Bedroom 5, Master Bath Tub/Spa Shower, Expanded Dining, California Room or Expanded Dining with California Room



U P P E R L E V E L

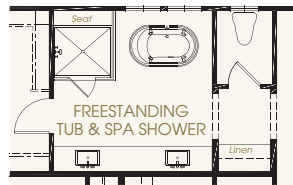

OPTION: Freestanding Tub and Spa Shower at Master Bath



OPTION: Bedroom 5 in lieu of Loft

FLOOR PLAN | SPANISH ELEVATION



*In an effort to continuously improve our product, we reserve the right to change elevations, specifications, materials, and price without prior notice. Variations in the floor plans and elevations may exist and square footages are approximate.*

Broker #  
01112962